

CERTIFICATE OF LOCATION OF GOVERNMENT CORNER

Northeast Corner of Section 7, Township 107, Range 43, 5th P.M.

STATE OF MINNESOTA, County of Murray

At the corner location shown on the sketch:

On 11-14-01 found a Nothing Definite
DATE

left monument as found, lowered monument, removed monument (explain)

On 11-14-01 placed a 5/8" rerod w/seal #11943
DATE

SKETCH OF REFERENCE TIES

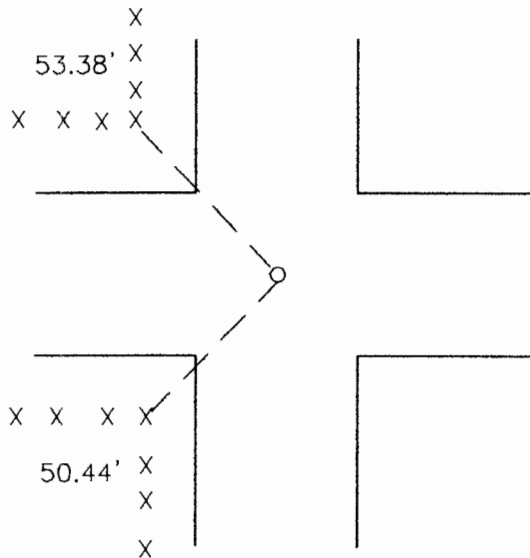

Nail and seal in CFP Southwest 50.44'

Nail and seal in CFP Northwest 53.38'

Statement of evidence relative to this corner location is on back of page.

I hereby certify that this document and the data contained herein was prepared by me or under my direct supervision.

Lyle P. Mooring 12-10-01
SIGNATURE DATE

Registration No. 11943

- Land Surveyor, Professional Engineer
 County Surveyor, County Engineer

OFFICE OF THE COUNTY RECORDER

County of _____ **DEC 27 2001**

I hereby certify that this document was filed in the Co. Recorders office at _____ .M on the _____ day of _____ A.D. 19__

County Recorder _____

By _____, Deputy

DOCUMENT NO. _____

Statement of Evidence

The original Survey was done in 1866, by J.W. Bishop

On 11-14-01 Moseng Land Surveying and Clyde Krog dug with a backhoe and found a small stone 3' off line. We also found other small stones in the area. We did not exopt the stones. We set a 5/8" rerod w/seal using occupation lines.